



34 Saxon Leas

Salisbury, SP5 1RW

£275,000



A well presented modern three bedroom house located near the centre of the village. The house has the benefit of oil fired central heating, backup solar panels and double glazing. There is an enclosed garden to the rear as well as a garage in a nearby block.



Directions

Enter Winterslow, go past the Hall on the right, then turn left into Youngs Paddock. Follow the road round into Saxon Leas and number 34 is on the left hand side.

Entrance Hall

Radiator. Stairs to first floor with 2 x cupboards.

Cloakroom

White WC and wash hand basin.

Sitting Room 15'5" x 10'5" (4.7m x 3.2m)

Ornamental fireplace with electric fire. Radiator. Television aerial point.

Dining Room 10'7" x 9'3" (3.23m x 2.84m)

Radiator.

Kitchen

Single drainer sink unit. Plumbing and space for washing machine. Electric cooker with extractor hood over. Base and drawer units. Wall cupboards. Radiator. Door to rear garden.

First Floor Landing

Access to loft space.

Bedroom One 11'9" x 10'4" (3.59m x 3.16m)

Radiator.

Bedroom Two 10'4" x 9'8" (3.16m x 2.95m)

Radiator.

Bedroom Three 9'9" x 8'2" (2.98m x 2.49m)

Radiator.

Bathroom

Panelled bath and shower, white WC and wash hand basin, radiator, linen cupboard with heater.

Outside

To the front is an area of lawn with flower beds and on-road parking.

To the rear is an enclosed area of lawn with flower beds, large oil tank, and Navien oil boiler. Separate pedestrian access to garage (4.83m x 2.45m), found in block of 4 to the rear, second from the right.

Area Map



Floor Plans

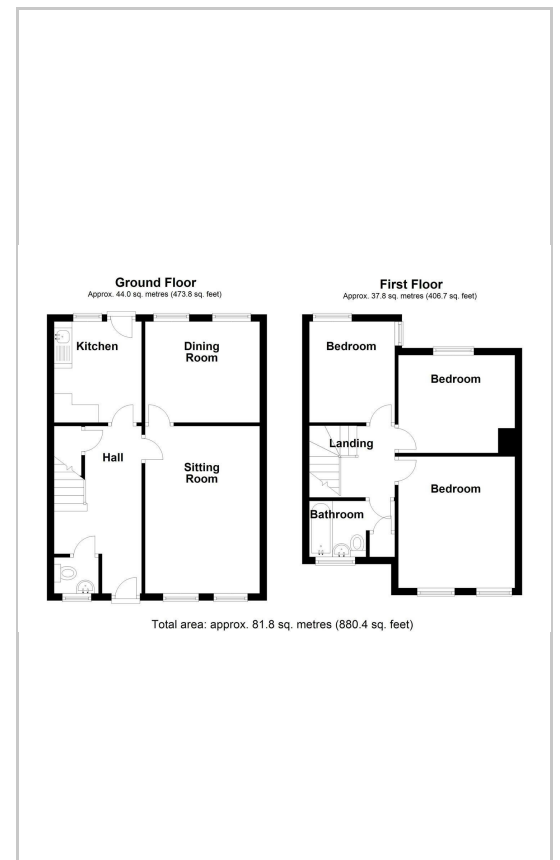

Energy Efficiency Graph

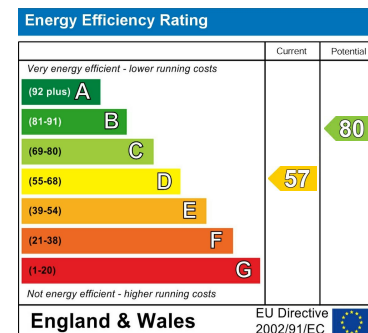

These particulars, whilst believed to be accurate are set out as a general outline only for guidance and do not constitute any part of an offer or contract. Intending purchasers should not rely on them as statements of representation of fact, but must satisfy themselves by inspection or otherwise as to their accuracy. No person in this firm's employment has the authority to make or give any representation or warranty in respect of the property.

St Mary's House Netherhampton Business Park, Salisbury, SP2 8PU

Tel: 01722 411151 Email: enquiries@venditum.co.uk <https://www.venditum.co.uk>